



## VEHICLE LIFT ECH

The ECH lift is designed for the vertical transportation of vehicles including their occupants.

### Machinery Directive

It is a lifting platform with direct acting hydraulic drive. The lifting platform has two facing guiding columns, one on each side of the car. The sling and the cylinders are supplied preassembled on these columns.

It is ideal for installation in buildings with a garage to be used for one or more families (where the construction of an access ramp is not possible) or to replace existing vehicle lifts.

The quality of the ECH lift exceeds that of other vehicle lifts due to its greater stability. The two-column design can lift heavier loads and be made up to 3 meters wide.

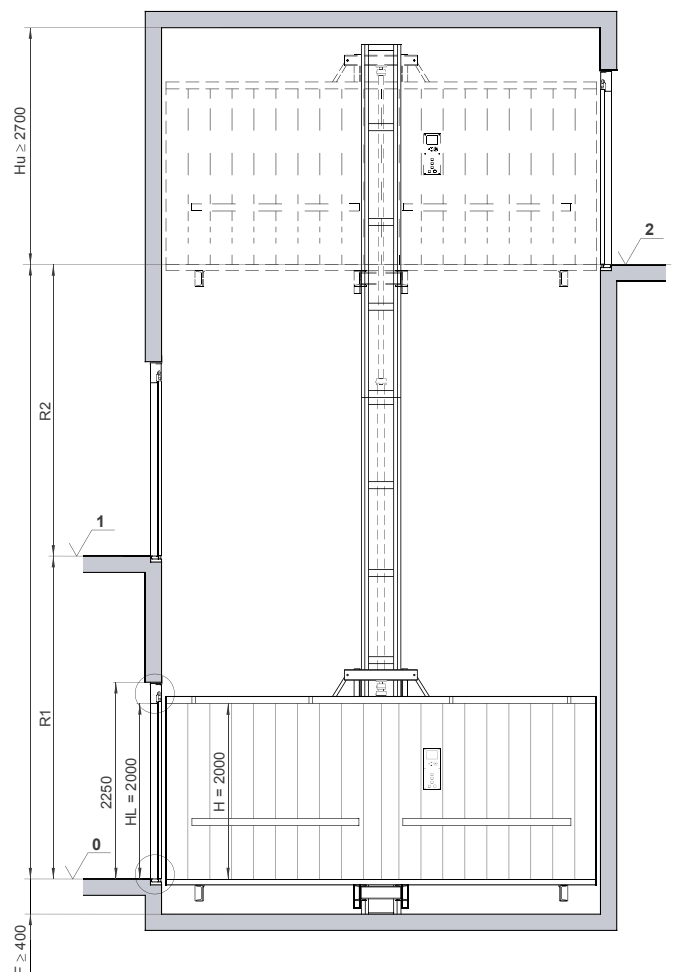

Minimum shaft dimensions, elevation view

**R** Travel

**F** Pit (maximum 1,800 mm)

**Hu** Headroom

**H** Car height

**HL** Door clear height

# ECH

## ECH VEHICLE LIFT



It is ideal for installation in buildings with a garage to be used by one or more families (where the construction of an access ramp is not possible) or to replace existing vehicle lifts.

## GENERAL CHARACTERISTICS

Model	ECH
Load capacity	2.000 - 3.500 Kg
Surface area	17,5 m <sup>2</sup>
Maximum travel*	7 m
Speed	0,10 m/s
Entrance	Single or double (180°)
Stops	2 - 3

(\*) Consult for greater travel distances.



Double-lateral column (optional)

## AESTHETIC AND FUNCTIONAL SOLUTIONS

### In the car

- Walls painted with a polyester-epoxy powder coating in light grey with matching metal protections (or wood as an option).
- Grey chequered plate. Lighting using fluorescent bulbs in the upper reinforcements of the side walls.
- COP (Car operating panel) with stop button, emergency lighting, intercom, load indicator and key enabling switch.
- Hold-to-run in the cabin with preference of use over landing push buttons.

### At landing

- Automatic slat sliding doors with electric locking. They are stored at the side in the space between the guides and the shaft wall. High-resistance 40 mm thick bumpers (consult colours available).
- Button panel with key enabling switch and car busy light indicator. Call remote control (optional).



Detail of the protections



Hold-to-run operated